

# One of the most attractive museums in the world



MAS Antwerp places its trust in solutions from the primion subsidiary GET

**The “Museum Aan de Stroom” (Museum on the River) in Antwerp is known as one of the most attractive museums in the world. Every day, some 3,500 visitors pass through the doors of the architecturally stunning building that was opened in 2011.**

The six metre glass façade offers an impressive view across the whole of Antwerp and at 60 metres high, the viewing platform on the roof gives visitors a breath-taking 360° panorama over the city, the river and the harbour. Around 100 staff work at the MAS. And they all use the software and hardware from primion’s Belgian subsidiary GET. Time recording and Access control operate as an integrated solution. A modern application that also matches the spirit of the young, bustling museum, located in one of Antwerp’s most sought after quarters, the “Eilandje”.

The city of Antwerp and the Public Social Welfare Centre (OCMW) already implemented the Time recording and Access control solution from GET some years ago. GET has now supplied the museum with a tailored software and

hardware solution for Access control. The compatibility with the existing system at the city authorities and the OMCW was a significant factor in awarding the order.

The architecture of the MAS’s outstanding cubist-inspired building imposed strict aesthetic guidelines for the readers, which, according to the demands of the architect, were effectively to be “invisible”. primion GET supplied them in the desired RAL colour so that they were integrated discretely and unobtrusively.

The MAS Antwerp fulfils a number of different functions. It is a museum, an event location, offices and a restaurant in one. A flexible software and a well thought-out approach to the access profiles and times were called for. The main task of the Access control system is to provide separation between the public and the non-public areas of the building. Staff doors were equipped with access readers. Visitors to the museum have no access rights at these doors. There are further access limitations within the non-public area, e.g. for the plant room.

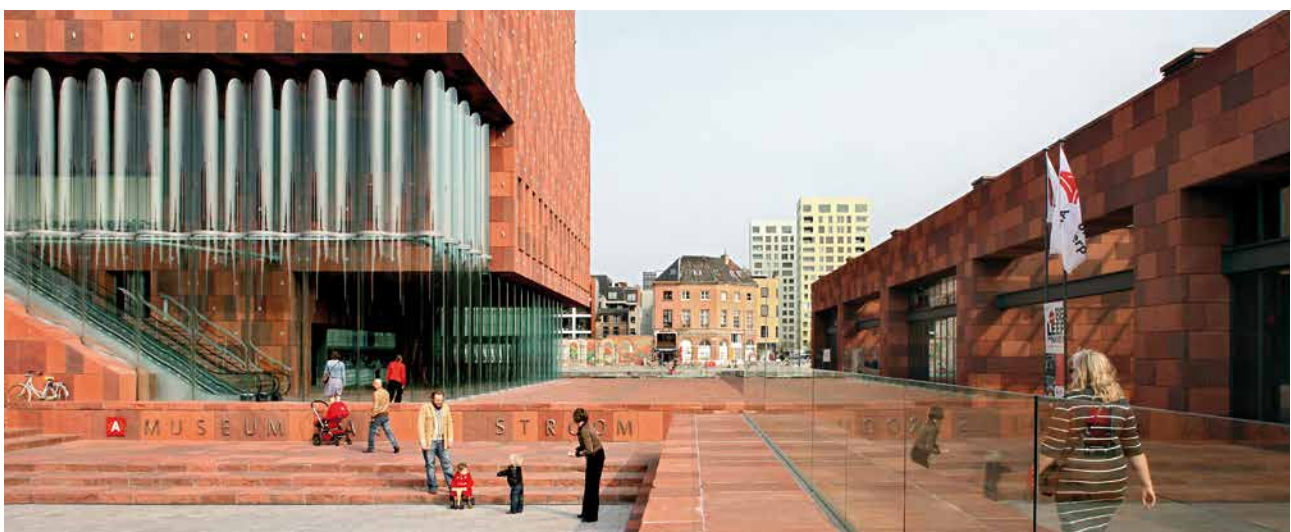

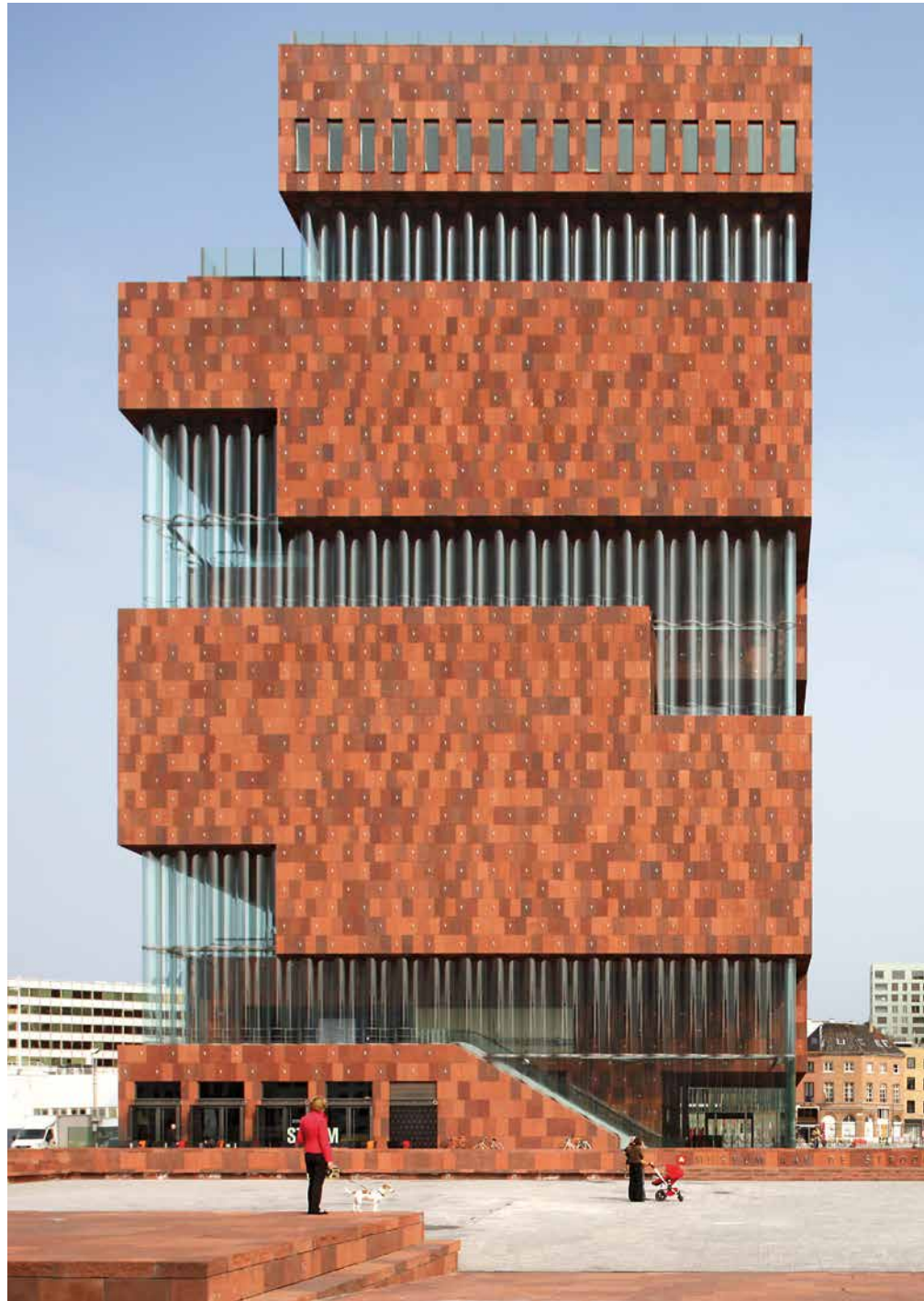

*There are strict guidelines in place for the protection of art and heritage in public buildings, which are fulfilled by the solutions provided by the primion subsidiary, GET.*



But even in the public area, not all rooms are accessible to the visitors. Access to the exhibition material storage areas is also secured with readers. Some of the exhibition rooms are open longer on certain days, for safety reasons, the roof area should be closed off in the event of bad weather and access to the event rooms is only permitted while events are actually going on. Here, the primion GET software also offers sufficient flexibility to be able to handle all these aspects.

If events are taking place, the Administrator can issue special cards for security and external staff, giving limited access to certain areas, both in terms of where and when access is possible. Use of the elevators is also controlled in line with the specifications of the MAS. The public elevator can be used by all. Using their access cards and the corresponding readers in the elevators, staff can control access to the different floors. Visitors only have access rights to defined areas and delivery companies have time-limited access to the floors that they need to get to.

Regulations in respect of fire protection are also adhered to through an interface to the Building Management System. Incoming fire notifications are transmitted to the door control module. Once security staff have confirmed the fire alarm, an acoustic alarm is activated throughout the building and all relevant doors are immediately unlocked. This guarantees a quick and safe evacuation of the building. Through the realtime checking of alarms, the Administrator can evaluate what the actual risk situation is. To support this, video cameras were installed that can zoom in on the location that the alarm has come from. The Administrator can react quickly and appropriately, even from home if necessary.

The reporting functions of the application also deliver an overview of the access authorisations that are in place for specific rooms, e.g. the exhibition material storage area. The importance of this feature should not be underestimated in a museum packed with as many valuable artefacts as the MAS. The daily report includes important information about where access was last granted to which badges or which issued badges have not yet been returned and should therefore be blocked. Systematic monitoring is very necessary with the large number of access cards in use here.

As with most of the city's employees and those working at the Antwerp OCMW, staff at the MAS also have flexible working hours to a large extent. Their daily bookings at the time recording terminals, the administration of their vacation requests, overtime or illness days are all handled by the Web module in the primion GET Time recording software. The data is processed through SAP at the city's central HR Department and at the OCMW. This provides a very comfortable, efficient and transparent solution for HR staff. Wim Audiens, a member of the Technical Service team: "I can work well with the application because the training we were given by the GET specialists was very informative and thorough. Access control from primion GET is one of the cornerstones of security at the MAS."